

Paper cutting

11.30am – 1pm & 2-3.30pm

POCAHONTAS CLASSROOM

Discover the ancient Chinese art of papercutting and have a go yourself. What masterpiece will you create?

Ages 5+

Trays of togetherness

11am – 12.30pm & 1.30-3pm

JACK PETCHY CLASSROOM

Explore the Chinese tradition of sharing food over the festive season by designing and creating your own 'tray of togetherness.' Fill your tray with treats that symbolise prosperity, luck, happiness and much more, then share these goodies with friends and family to celebrate the new year.

Ages 5+

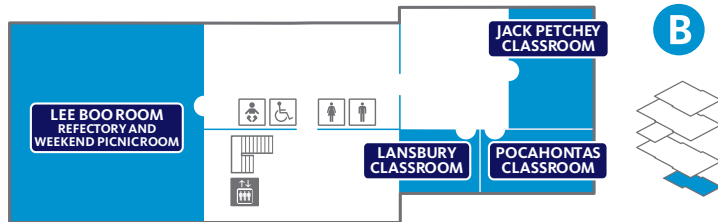

Food and Drink

- The museum café offers locally sourced and seasonal produce on its menu
- Create your own children's lunch box including juice, a sandwich and snacks for £4.95
- Rum & Sugar is just nextdoor to the museum and is open from 11am – 11pm (Tues-Sun)
- The restaurant features a children's menu with meals starting from £4.95
- There is a designated indoor family picnic area open until 5.30pm.

Family resources

Family trails and backpacks are available to borrow every day from the information desk. A refundable deposit is required for the bags.

All aboard!

Saturday 11 – Sunday 19 February

Take a closer look at the many ways Londoners both past and present travelled through the city in this week of fun, hands-on activities all about transportation.

Illustration by Rose Lloyd



HAPPY
CHINESE
NEW YEAR
欢乐春节

Chinese New Year

28 January 2017, 11am – 4pm

Celebrate the year of the rooster at this special family event. Fill a tray of togetherness, try your hand at paper-cutting, fashion a zodiac-inspired mobile, listen to traditional Chinese stories, take part in a dragon dance and much more. What better way to start the new year?



It's all Chinese to me

12pm, 1pm & 3pm (45 mins duration)

QUAYSIDE ROOM

Do you think Mandarin is too difficult to master? You probably know more than you think! Explore this fascinating language and learn some basic words and characters through games, movement and writing in this ticketed workshop.

Tickets allocated upon arrival from the front desk.

Ages 5+

Melodies from China

2.15pm

QUAYSIDE ROOM

Join the Sishu Chinese School for traditional Chinese music and dancing. Hear the melodies of the Guzheng and watch demonstrations of traditional dances then try some moves out yourself.

Age 0+

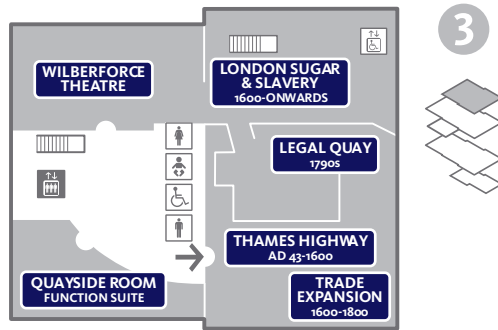

Play dough roosters

11am – 12.30pm & 1.30-3pm

No.1 WAREHOUSE

Join us as we celebrate the Year of the Rooster and use sparkly play dough to mould your very own rooster in this sensory activity for under 5s and their parents or carers.

All ages

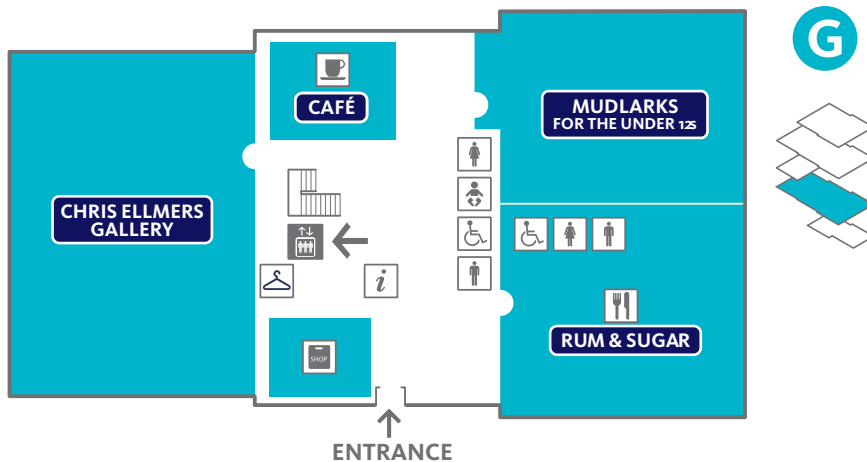

Tales from China's past

12-12.30pm, 1.30-2pm & 2.30-3pm

WAREHOUSE OF THE WORLD

Listen to classic Chinese folktales which would have travelled from China to London when Limehouse was the city's original Chinatown. Join us for tales about magical animals, sailing on the salty seas and filling the world with colours.

Ages 3+

Zodiac mobiles

12.30-2pm & 2.30-4pm

CITY & RIVER GALLERY

Bring all twelve animals of the zodiac together in this drop-in workshop. Make a colourful mobile inspired by the animals of the Chinese zodiac. Which one will be your favourite?

Ages 3+



Dragon puppets

12-1.30pm & 2.30-4pm

FOYER

Start the new year with some extra luck by making your own dragon mask. Then help decorate our giant dragon puppet for a dance performance at the end of the day.

Ages 3+

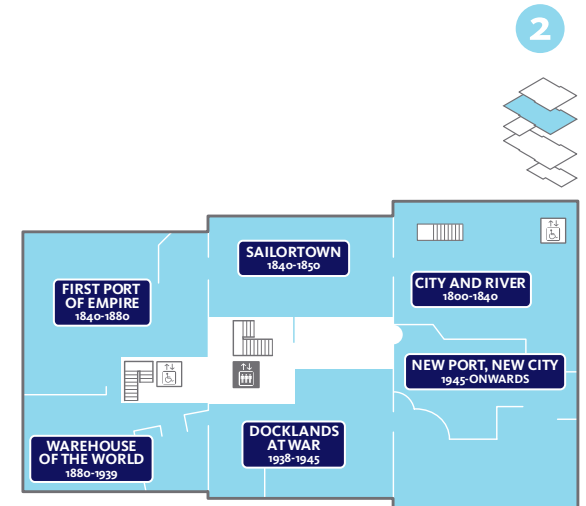

Dragon dance

4pm

FOYER

Take part in a traditional dragon dance and welcome in good fortune for the New Year.

Ages 3+